



FlexScan[®]
Business Monitor Solutions



Now, find your workstyle.

Both performance and environmental consciousness are important in today's society.

FlexScan combines cutting-edge technology with sustainable design to achieve the ideal in workstyle innovation.

Whether it be in the office or at home, FlexScan enables business professionals to achieve comfort and efficiency while staying kind to the environment.

Now, find your workstyle.



FlexScan®



Find the Solution that Suits Your Workstyle Needs.

Choose a Monitor by Your Workstyle

Having my battery always fully charged allows me to focus on work
See page 8

I need a stable network connection for web meetings
See page 9

I need a webcam & mic
See page 7

I need to use multiple monitors with less cable clutter
See page 9

I'm using a desktop PC and need a good monitor

I prefer to work with an external mouse and keyboard when using my laptop
See pages 8

Eye care and ergonomics are important to me
See pages 10 - 11

Inputs	USB Type-C®	✓	✓	✓	✓	✓	✓	✓	✓	✓	✓	✓	✓	✓	-	-	-
	Power Delivery	✓	✓	✓	✓	✓	✓	✓	✓	✓	✓	✓	✓	✓	-	-	-
	Network Connection	✓	✓	✓	✓	✓	✓	✓	✓	✓	-	-	-	-	-	-	-
	Daisy Chain	-	-	-	-	-	-	✓	✓	✓	-	-	-	-	-	-	-
	Webcam & Mic	-	-	✓	-	-	-	-	-	-	-	-	-	-	-	-	-
	DisplayPort™	✓	✓	✓	✓	✓	✓	✓	✓	✓	✓	✓	✓	✓	✓	✓	✓
	HDMI®	✓	✓	✓	✓	✓	✓	✓	✓	✓	✓	✓	✓	✓	✓	✓	✓
	DVI-D	-	-	-	-	-	-	-	-	-	-	-	-	-	✓	-	-
	D-Sub mini 15 pin	-	-	-	-	-	-	-	-	-	-	-	-	-	✓	-	✓
	Eye Care Functions	✓	✓	✓	✓	✓	✓	✓	✓	✓	✓	✓	✓	✓	✓	✓	✓
USB Ports	3	4	3	4	4	4	4	4	4	4	4	4	4	4	4	2	

Premium

New Standard

Basic

Premium Plus

	Premium Plus							Premium		New Standard				Basic		
	EV4340X	EV3851X	EV3450XC	EV3451X	EV3240X	EV2740X	EV2795	EV2495	EV2490	EV2740S	EV2720S	EV2485	EV2480	EV2410R	EV2400R	EV2360
Panel Size	42.5"	37.5" Curved	34.1" Curved	34.1" Curved	31.5"	27"	27"	24.1"	23.8"	27"	27"	24.1"	23.8"	24.1"	23.8"	22.5"
Native Resolution	4K 3840×2160	UWQHD+ 3840×1600	UWQHD 3440×1440	UWQHD 3440×1440	4K 3840×2160	4K 3840×2160	WQHD 2560×1440	WUXGA 1920×1200	Full HD 1920×1080	4K 3840×2160	WQHD 2560×1440	WUXGA 1920×1200	Full HD 1920×1080	WUXGA 1920×1200	Full HD 1920×1080	WUXGA 1920×1200

Choose a Monitor by Size and Resolution

See pages 20 - 23 for a detailed list and specifications of the complete FlexScan lineup, including square and wide monitors.

Bask in Beauty.



Aesthetically Pleasing Design

The minimalist design of FlexScan monitors allows them to fit naturally in your work environment. Even with the black borders along the perimeter of the LCD there is very little distance between the display area of each screen in a multi-monitor configuration which makes for almost seamless viewing.

Tackle More with 4K

The EV4340X, EV3240X, EV2740X, and EV2740S support 4K (3840 x 2160 pixel) resolution, displaying four times the amount of information than standard Full HD (1920 x 1080 pixel) monitors. You can view more applications simultaneously on a single screen, greatly reducing the need to scroll or switch windows frequently.



Better Meeting Experience

The EV4340X displays at 4K resolution across a spacious 42.5-inch screen. The built-in 4-watt speakers provide clear audio for meeting spaces with several people. The included remote control can be used to change settings when the monitor is out of reach, such as in wall-mounted installations.



Contoured to Your Workstyle.



See Everything at a Comfortable Distance

The curved screen of the EIZO ultrawide monitors gently brings its edges in to a comfortable distance, improving visibility, focus, and immersion.



More Space, Seamless Viewing

The ultrawide screen provides an expanded workspace for flexible arrangement of multiple applications without the obtrusive bezels characteristic of multi-monitor setups.

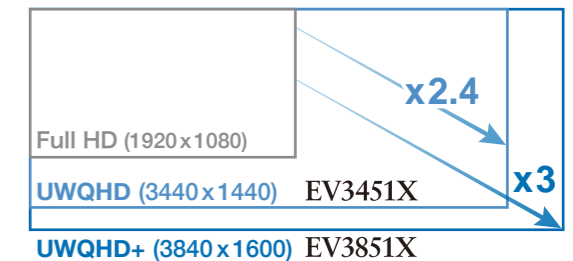

Built-In Webcam / Mic / Speaker

The EV3450XC's webcam, microphone, and speaker are discreetly integrated into the bezel to blend in with your workspace. High quality video and audio make it easy to communicate with colleagues.

Get Connected. Get Started.



Streamlined Connection with USB Type-C

USB Type-C compatible monitors make it faster and easier to connect a laptop when moving between workstations, or when working away from the office.



Power Delivery

Power delivery via USB Type-C reliably charges laptops and small desktop PCs. This eliminates the need for a laptop's bulky power supply unit, freeing up desk space.



Directly Connect Peripherals

Laptops often have limited connectivity options for peripherals. Connecting to a USB Type-C compatible monitor gives access to a hub with multiple USB Type-A ports for easily connecting an external keyboard, mouse, web camera, or storage device.



Stable Network Connection

While many modern laptops are not equipped with a dedicated LAN port, a USB Type-C compatible monitor with a built-in LAN adapter provides users with access to the network via the monitor. This allows users to conduct conference calls or data transfers reliably and at high speed.



Compatible Models

EV4340X / EV3851X / EV3450XC / EV3451X / EV3240X / EV2740X / EV2795 / EV2495 / EV2490

Protecting Network Security in Shared Workspaces

Social change has led to a diversification of workspace models and workstyles. More companies are adopting shared office spaces, conference rooms, and meeting spaces. EIZO MAC Address Clone Utility software is available to enable the convenient use of wired LAN functions in a secure environment through MAC address authentication when using EIZO LAN port monitors in such spaces. *Supports Windows OS only.*



Daisy Chain

With a daisy chain users can connect multiple monitors via a single video signal output. Connecting monitors in a daisy chain simplifies cable management, tidying up the back of the desk for an even cleaner office aesthetic.

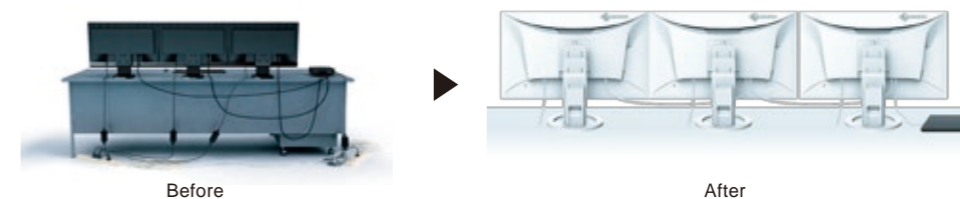

Compatible Models

EV2795 / EV2495 / EV2490



Visit Our Website

Infographic: "What is USB Type-C?"



Visit Our Website

What do I need to know about daisy chaining?



Say Goodbye to Tired Eyes.



Glare Reduction

Anti-Glare Coating

FlexScan monitors are treated with an anti-glare coating to reduce screen reflections caused by ambient lighting. The coating scatters incoming light, reducing the amount of light reflected into your eyes.

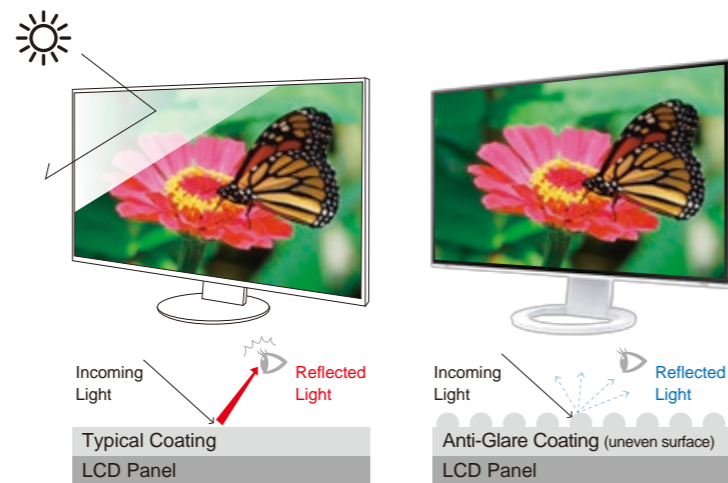

Flicker-Free Viewing

EyeCare Dimming Mode

Due to the way brightness is controlled on LED backlights, some users may experience flicker on the screen, causing eye fatigue. FlexScan monitors use a hybrid solution to regulate brightness and eliminate perceived flicker without compromising color stability, even at low brightness settings.



FlexScan monitors are certified by TÜV Rheinland to have low blue light and be flicker-free.

Auto Brightness Control

Always the Ideal Brightness

The Auto EcoView function automatically adjusts the brightness of your monitor according to ambient lighting. This ensures your monitor is always at the optimal brightness for reducing eye fatigue.



Blue Light Reduction

Paper Mode

Do you find that your screen is often too bright to read text comfortably? FlexScan monitors are equipped with Paper Mode which reduces blue light to simulate paper, making it less straining on your eyes. When used in conjunction with the Auto EcoView function, blue light is even further reduced.

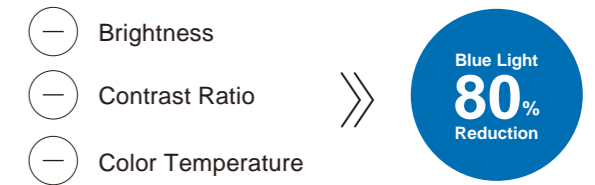

Stable Image Even at Low Brightness

Reduce Brightness to Approximately 1 cd/m²

Most FlexScan monitors can be adjusted to a brightness of approximately 1 cd/m² without negatively impacting the color or stability of the screen.

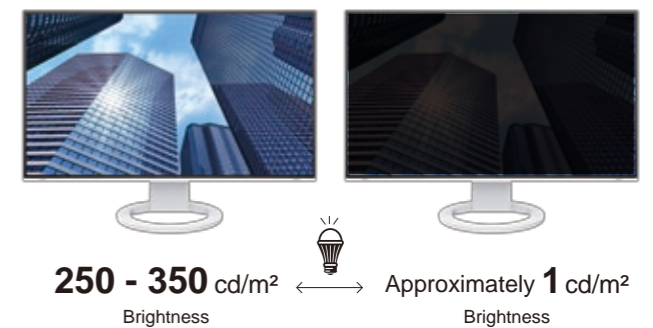

[Visit Our Website](#) | "The Latest on Computer Screens and Eye Fatigue"

[Visit Our Website](#) | "Designed to Protect Your Eyes"

The Perfect Position.



Versatile Stand

The stands feature height adjustment, tilt, and swivel, while saving space and remaining stylish. Quickly and smoothly adjust your monitor to the perfect position.

Stand movement range varies by model. See pages 20 - 23 for specifications of all monitors.

■ EV2795

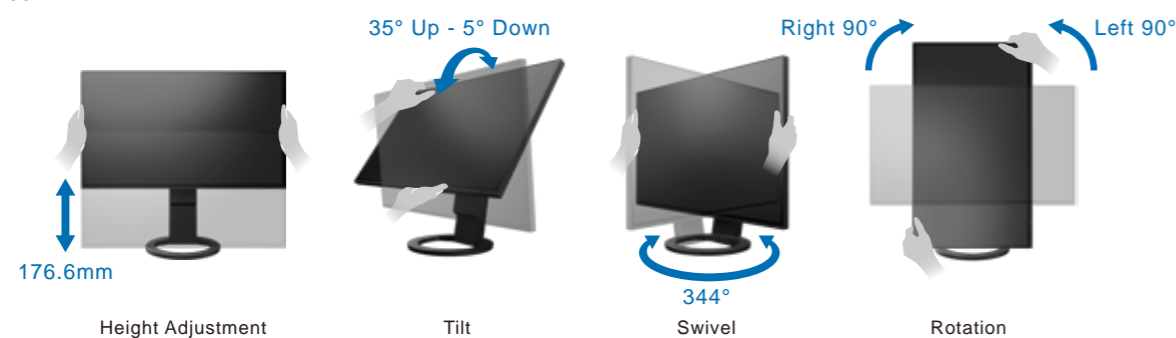

Wide Height Adjustment Range

The ergonomic stand allows you to adjust the monitor to the most comfortable position suited for the workplace or home office.

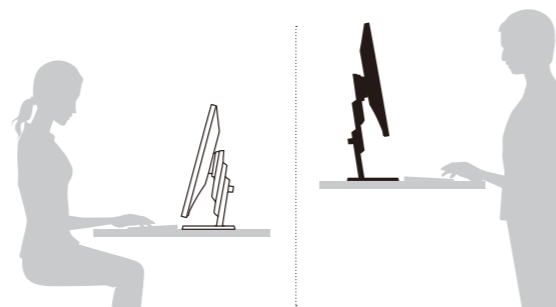

Space-Saving Positioning

For the most limited workspaces, a laptop can fit comfortably under the monitor with the stand at maximum height. This allows you to use the laptop as a second screen without taking up valuable desktop space.

Stand movement range varies by model. See pages 20 - 23 for specifications of all monitors.

■ EV2480



Free Up Your Workspace

VESA-compliant stand brackets let you easily mount a client terminal such as a thin client or mini PC to the back of the monitor. The space the client terminal previously occupied is now freed up so you can make better use of your desktop. Even with the client terminal attached you can adjust the monitor's stand freely.

Please check EIZO website for supported models.

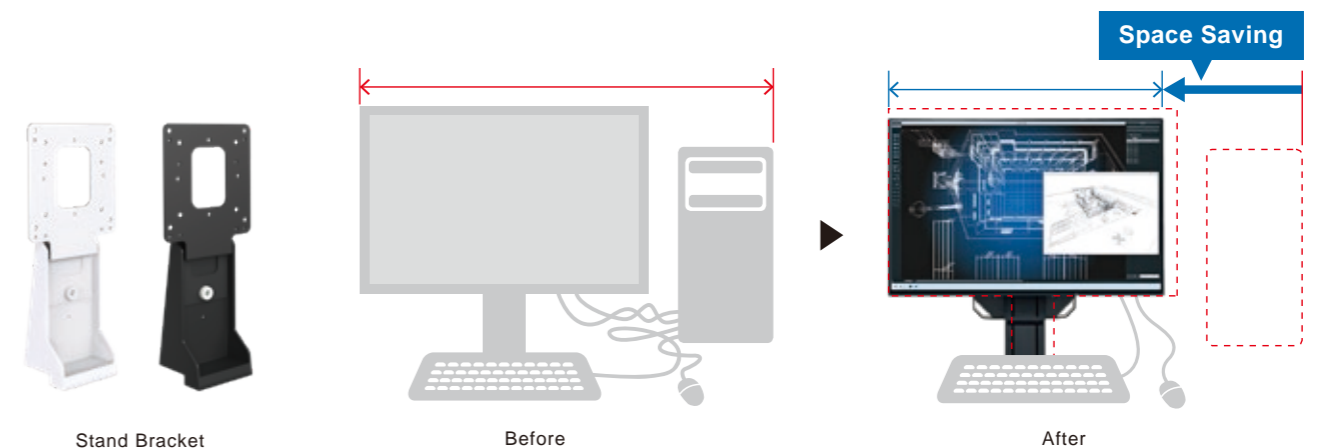

Visit Our Website

Case Studies: See how EIZO is used in a variety of environments



Intelligent Software to Work Better.

SCREEN INSTYLE

EIZO's free Screen InStyle software streamlines screen management of single and multi-monitor environments for a better working experience.

Available on both Windows and macOS operating systems.

See pages 20 - 23 for compatible monitors.

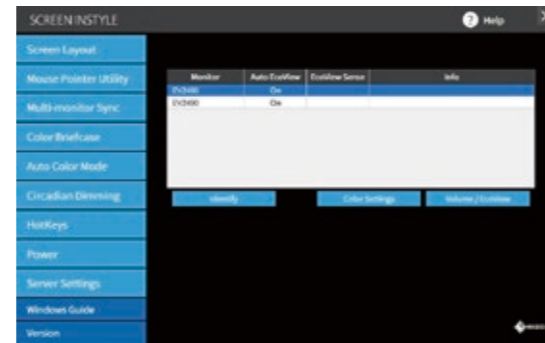

Automatically Change the Color Mode for Each Application

Auto Color Mode

FlexScan monitors have multiple color modes designed for different uses. Use the Auto Color Mode to assign a color mode to turn on when using specific applications such as those for writing documents, photo viewing, creating illustrations or watching movies. When an application is opened the screen will automatically switch to the assigned color mode, making manual switching unnecessary.



Color Briefcase

Effortlessly maintain your personalized screen preferences wherever you go. Color mode and display settings are automatically applied when you connect your laptop to a monitor supported by Screen InStyle, making it ideal for hot-desking and shared workspaces.



Organize Your Desktop to Increase Work Efficiency

Screen Layout

This function allows you to divide your desktop and arrange each program's window neatly across the screen, helping you work smarter and more efficiently.

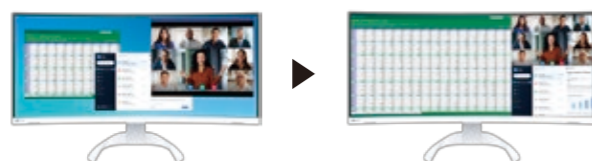

Easily Switch Between Inputs / Color Modes

Assign Hotkeys for Switching Input Signals and Color Modes

With the hotkey function, you can assign keyboard shortcuts to instantly switch between color modes or input signals from two PCs connected to your monitor.



Multi-Monitor Convenience

Synchronize Screen Adjustments

When using multiple monitors, save time by synchronizing all the monitors with each other. If you change the color mode, brightness or color temperature of one monitor, the rest will automatically change to the same.

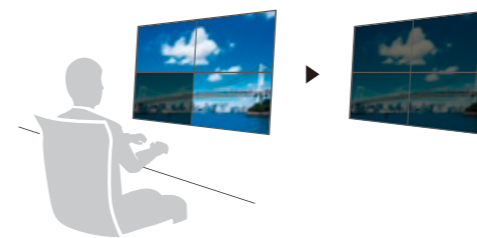

On/Off All at Once

When one monitor's power is turned off, all other monitors will also turn off. Save energy by easily turning off all monitors at once.

Available on Windows operating systems only.

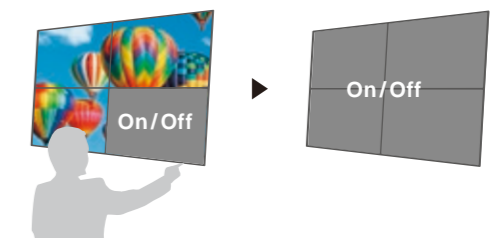

Screen InStyle Server

Effectively Monitor Asset Management

Screen InStyle Server is available on Windows operating systems only.

Automatically Receive Monitor or PC Information

With Screen InStyle Server receive information such as the model name and serial number of any monitor connected to your network. Additionally, see information from the computer that each monitor is connected to, such as the OS, IP address and computer name.

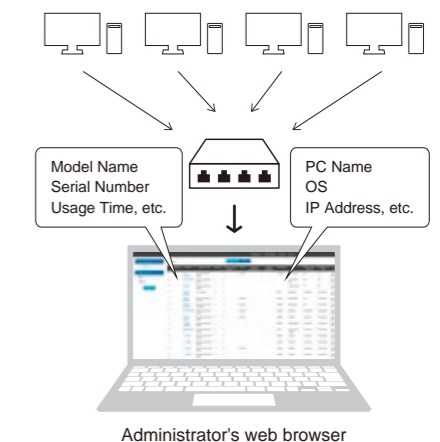

Control Settings on Multiple Monitors at Once

Easily manage multiple monitors by remotely controlling settings like color mode, brightness, and eco functions. You can centrally configure power settings for both networked monitors and PCs, including options to turn them off or enter sleep mode after a predefined period of inactivity. This contributes to meaningful energy savings across your organization.

Care for the Environment.



Leading the Way in Sustainability

EIZO is committed to environmentally conscious product development, from the manufacturing process to the user experience. FlexScan monitors are at the forefront of these efforts, supporting users and organizations concerned with sustainable procurement.

Certified Sustainable

FlexScan monitors are certified by worldwide comprehensive sustainability standards such as TCO Certified, ENERGY STAR®, and EPEAT.

Certification varies by model. See website for more details.



Low Environmental Impact Materials

The FlexScan lineup includes models that are made of more than 80% recycled plastic. This reduces the amount of plastic waste entering the environment, conserves resources, and promotes the reuse of materials to preserve the natural ecosystem.



Energy Efficiency

Cut power consumption by as much as 60% using EcoView technologies. The Auto EcoView function automatically adjusts the screen's brightness according to changes in ambient light, while the EcoView Optimizer 2 function fine-tunes the balance between brightness and gain according to the content displayed on the screen, contributing to a smaller carbon footprint.



[? Visit Our Website](#) |
 ["How Green is Your Monitor?" Eco Calculator](#)

Eco-Conscious Packaging

Most monitors are safely packed using molded pulp made from recycled cardboard and newspaper. Their cables are also wrapped in paper instead of plastic bags.



Collective Packaging Options

Collective packaging options are available to support corporate sustainability. Multiple monitors are packaged in a single box, while the stands are packaged separately or excluded entirely, improving loading efficiency and streamlining installation.

Eco-Consciousness and Workstyle Innovation

FlexScan reflects EIZO's sustainability focus through eco-conscious design, including the use of recycled materials, low-impact components, and energy efficiency. Additionally, user-focused features support diverse workstyles, enabling more comfortable and productive work. These efforts contribute to EIZO's broader commitment to the Sustainable Development Goals (SDGs).

SUSTAINABLE DEVELOPMENT GOALS

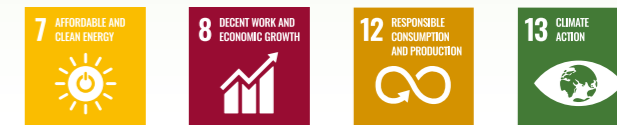

Warranty of Trust, Powered by Our Confidence in Quality

In June 2026, we introduced the world's first¹ 7-year monitor warranty² for select models in the FlexScan EV series. This extended warranty reflects our commitment to high-quality, highly reliable product design, backed by rigorous quality control.

*1 According to EIZO's research as of June 2026.
2 Usage time is limited to 30,000 hours.
See pages 20 - 23 for warranty periods of all monitors.*



Integrated Approach

Through complete in-house control of development, manufacturing, and quality assurance, EIZO maintains consistent quality and long-term reliability. This integrated approach enables EIZO to confidently offer a 7-year warranty.



Visual Technology Company



50+ Years of Expertise

Innovative Solutions

Extensive Market Reach

Built-In Color Calibration Sensors



Automatically calibrates while you work



FlexScan

Business Enterprise



ColorEdge

Creative Work

IP Decoding Solutions

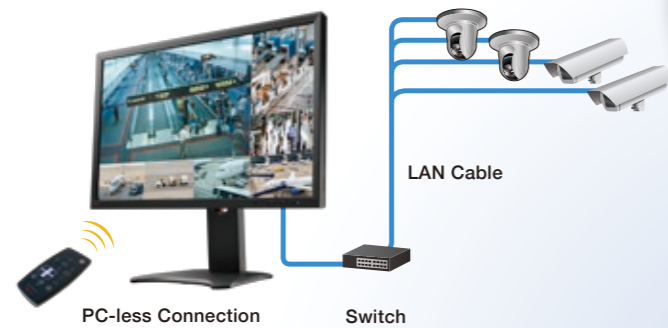

Visibility Enhancement Technology



Research and Development



Global Reach



CuratOR / RadiForce

Healthcare

Market-Focused Cloud Solutions



Manufacturing



Customization



DuraVision / VisionCore

Security / Infrastructure / Maritime



Quality Control

Software for Improved Workflow



Use a single mouse across two PCs

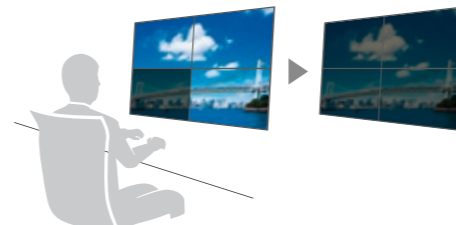

Synchronized adjustment of multiple monitors



Simplified CMS with automatic software and printer settings adjustment



Raptor / Re/Vue / SafeGuard

Air Traffic Control

FlexScan

Specifications

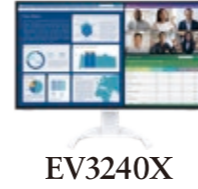

EV4340X

EV3851X

EV3450XC

EV3451X

EV3240X

EV2740X

EV2795

EV2495

EV2490

EV2740S

			Premium Plus				Premium				New Standard	
Model Variations	With Stand	Black	EV4340X-BK	EV3851X-BK	EV3450XC-BK	EV3451X-BK	EV3240X-BK	EV2740X-BK	EV2795-BK	EV2495-BK	EV2490-BK	EV2740S-BK
		White	EV4340X-WT	EV3851X-WT	EV3450XC-WT	EV3451X-WT	EV3240X-WT	EV2740X-WT	EV2795-WT	EV2495-WT	EV2490-WT	EV2740S-WT
	Without Stand	Black	EV4340X-FBK	EV3851X-FBK	EV3450XC-FBK	EV3451X-FBK	EV3240X-FBK	EV2740X-FBK	EV2795-FBK	EV2495-FBK	EV2490-FBK	EV2740S-FBK
		White	EV4340X-FWT	EV3851X-FWT	EV3450XC-FWT	EV3451X-FWT	EV3240X-FWT	EV2740X-FWT	EV2795-FWT	EV2495-FWT	EV2490-FWT	EV2740S-FWT
Panel	Type		IPS	IPS, curvature 2300R	IPS, curvature 3800R	IPS, curvature 3800R	IPS	IPS	IPS	IPS	IPS	IPS
	Backlight		LED	LED	LED	LED	LED	LED	LED	LED	LED	LED
	Size		42.5" (108.0 cm)	37.5" (95.3 cm)	34.1" (86.7 cm)	34.1" (86.7 cm)	31.5" (80.0 cm)	27.0" (68.5 cm)	27.0" (68.5 cm)	24.1" (61.1 cm)	23.8" (60.5 cm)	27.0" (68.5 cm)
	Native Resolution		3840 x 2160 (16:9 aspect ratio)	3840 x 1600 (24:10 aspect ratio)	3440 x 1440 (21:9 aspect ratio)	3440 x 1440 (21:9 aspect ratio)	3840 x 2160 (16:9 aspect ratio)	3840 x 2160 (16:9 aspect ratio)	2560 x 1440 (16:9 aspect ratio)	1920 x 1200 (16:10 aspect ratio)	1920 x 1080 (16:9 aspect ratio)	3840 x 2160 (16:9 aspect ratio)
	Viewable Image Size (H x V)		941.2 x 529.4 mm	879.7 x 366.5 mm	799.8 x 334.8 mm	799.8 x 334.8 mm	697.3 x 392.2 mm	596.7 x 335.7 mm	596.7 x 335.7 mm	518.4 x 324 mm	527 x 296.5 mm	596.7 x 335.7 mm
	Pixel Pitch (H x V)		0.245 x 0.245 mm	0.229 x 0.229 mm	0.233 x 0.233 mm	0.233 x 0.233 mm	0.182 x 0.182 mm	0.155 x 0.155 mm	0.233 x 0.233 mm	0.270 x 0.270 mm	0.275 x 0.275 mm	0.155 x 0.155 mm
	Pixel Density		104 ppi	111 ppi	109 ppi	109 ppi	140 ppi	163 ppi	109 ppi	94 ppi	93 ppi	163 ppi
	Display Colors		16.77 million	16.77 million	16.77 million	16.77 million	16.77 million	16.77 million	16.77 million	16.77 million	16.77 million	16.77 million
	Viewing Angles (H / V, typ.)		178° / 178°	178° / 178°	178° / 178°	178° / 178°	178° / 178°	178° / 178°	178° / 178°	178° / 178°	178° / 178°	178° / 178°
	Brightness (typ.)		350 cd/m ²	300 cd/m ²	300 cd/m ²	350 cd/m ²	350 cd/m ²	350 cd/m ²	350 cd/m ²	350 cd/m ²	250 cd/m ²	350 cd/m ²
Contrast Ratio (typ.)		1000:1	2000:1	1000:1	1000:1	2000:1	2000:1	1000:1	1000:1	1000:1	1000:1	
Response Time (typ.)		5 ms (gray-to-gray)	5 ms (gray-to-gray)	5 ms (gray-to-gray)	5 ms (gray-to-gray)	5 ms (gray-to-gray)	5 ms (gray-to-gray)	5 ms (gray-to-gray)	5 ms (gray-to-gray)	5 ms (gray-to-gray)	6 ms (gray-to-gray)	
Video Signals	Input Terminals		USB Type-C (DisplayPort Alt Mode, HDCP 2.3 / 1.3), DisplayPort (HDCP 2.3 / 1.3), HDMI (HDCP 2.3 / 1.4) x 2	USB Type-C (DisplayPort Alt Mode, HDCP 2.3 / 1.3), DisplayPort (HDCP 2.3 / 1.3), HDMI (HDCP 2.3 / 1.4) x 2	USB Type-C (DisplayPort Alt Mode, HDCP 2.3 / 1.3), DisplayPort (HDCP 2.3 / 1.3), HDMI (HDCP 2.3 / 1.4) x 2	USB Type-C (DisplayPort Alt Mode, HDCP 2.3 / 1.3), DisplayPort (HDCP 2.3 / 1.3), HDMI (HDCP 2.3 / 1.4) x 2	USB Type-C (DisplayPort Alt Mode, HDCP 2.3 / 1.3), DisplayPort (HDCP 2.3 / 1.3), HDMI (HDCP 2.3 / 1.4) x 2	USB Type-C (DisplayPort Alt Mode, HDCP 2.3 / 1.3), DisplayPort (HDCP 2.3 / 1.3), HDMI (HDCP 2.3 / 1.4) x 2	USB Type-C (DisplayPort Alt Mode, HDCP 1.3), DisplayPort (HDCP 1.3), HDMI (HDCP 1.4)	USB Type-C (DisplayPort Alt Mode, HDCP 1.3), DisplayPort (HDCP 1.3), HDMI (HDCP 1.4)	USB Type-C (DisplayPort Alt Mode, HDCP 1.3), DisplayPort (HDCP 1.3), HDMI (HDCP 1.4)	USB Type-C (DisplayPort Alt Mode, HDCP 2.3 / 1.3), DisplayPort (HDCP 2.3 / 1.3), HDMI (HDCP 2.3 / 1.4)
	Output Terminals		-	-	-	-	-	-	USB Type-C (daisy chain)	USB Type-C (daisy chain)	USB Type-C (daisy chain)	-
USB	Upstream		USB 5Gbps: Type-B, USB 5Gbps: Type-C (DisplayPort Alt Mode, Power Delivery Source 94 W max.)	USB 5Gbps: Type-B, USB 5Gbps: Type-C (DisplayPort Alt Mode, Power Delivery Source 94 W max.)	USB 5Gbps: Type-B, USB 5Gbps: Type-C (DisplayPort Alt Mode, Power Delivery Source 94 W max.)	USB 5Gbps: Type-B, USB 5Gbps: Type-C (DisplayPort Alt Mode, Power Delivery Source 94 W max.)	USB 5Gbps: Type-B, USB 5Gbps: Type-C (DisplayPort Alt Mode, Power Delivery Source 94 W max.)	USB 5Gbps: Type-B, USB 5Gbps: Type-C (DisplayPort Alt Mode, Power Delivery Source 94 W max.)	USB 5Gbps: Type-B, USB 5Gbps: Type-C (DisplayPort Alt Mode, Power Delivery Source 70 W max.)	USB 5Gbps: Type-B, USB 5Gbps: Type-C (DisplayPort Alt Mode, Power Delivery Source 70 W max.)	USB 5Gbps: Type-B, USB 5Gbps: Type-C (DisplayPort Alt Mode, Power Delivery Source 70 W max.)	USB 5Gbps: Type-C (DisplayPort Alt Mode, Power Delivery Source 94 W max.)
	Downstream		USB 5Gbps: Type-A x 2, USB 5Gbps: Type-C (Type-C Current, 15 W max.)	USB 5Gbps: Type-A x 3, USB 5Gbps: Type-C (Type-C Current, 15 W max.)	USB 5Gbps: Type-A x 2, USB 5Gbps: Type-C (Type-C Current, 15 W max.)	USB 5Gbps: Type-A x 3, USB 5Gbps: Type-C (Type-C Current, 15 W max.)	USB 5Gbps: Type-A x 3, USB 5Gbps: Type-C (Type-C Current, 15 W max.)	USB 5Gbps: Type-A x 3, USB 5Gbps: Type-C (Type-C Current, 15 W max.)	USB 5Gbps: Type-A x 3, USB 5Gbps: Type-C (DisplayPort Alt Mode, Power Delivery Source 15 W max.)	USB 5Gbps: Type-A x 3, USB 5Gbps: Type-C (DisplayPort Alt Mode, Power Delivery Source 15 W max.)	USB 5Gbps: Type-A x 3, USB 5Gbps: Type-C (DisplayPort Alt Mode, Power Delivery Source 15 W max.)	USB 5Gbps: Type-A x 4
	USB LAN Adapter		RJ-45 (1000BASE-T) Windows 11, Windows 10 (64-bit, 32-bit), macOS Sierra (10.12) or later	RJ-45 (2.5GBASE-T) Windows 11, macOS Monterey (12) or later	RJ-45 (1000BASE-T) Windows 11, Windows 10 (64-bit, 32-bit), macOS Sierra (10.12) or later	RJ-45 (2.5GBASE-T) Windows 11, macOS Monterey (12) or later	RJ-45 (1000BASE-T) Windows 11, Windows 10 (64-bit, 32-bit), macOS Sierra (10.12) or later	RJ-45 (1000BASE-T) Windows 11, Windows 10 (64-bit, 32-bit), macOS Sierra (10.12) or later	RJ-45 (1000BASE-T) Windows 11, Windows 10 (64-bit, 32-bit), macOS Sierra (10.12) or later	RJ-45 (1000BASE-T) Windows 11, Windows 10 (64-bit, 32-bit), macOS Sierra (10.12) or later	RJ-45 (1000BASE-T) Windows 11, Windows 10 (64-bit, 32-bit), macOS Sierra (10.12) or later	-
Audio	Speakers		4.0 W + 4.0 W	2.0 W + 2.0 W	4.0 W + 4.0 W	2.0 W + 2.0 W	2.0 W + 2.0 W	2.0 W + 2.0 W	1.0 W + 1.0 W	1.0 W + 1.0 W	1.0 W + 1.0 W	1.0 W + 1.0 W
	Output Terminals		Headphones (Stereo mini jack)	Headphones (Stereo mini jack)	Headphones (Stereo mini jack)	Headphones (Stereo mini jack)	Headphones (Stereo mini jack), Line out (Stereo mini jack)	Headphones (Stereo mini jack), Line out (Stereo mini jack)	Headphones (Stereo mini jack)	Headphones (Stereo mini jack)	Headphones (Stereo mini jack)	-
Power	Power Input		AC 100 - 240 V, 50 / 60 Hz	AC 100 - 240 V, 50 / 60 Hz	AC 100 - 240 V, 50 / 60 Hz	AC 100 - 240 V, 50 / 60 Hz	AC 100 - 240 V, 50 / 60 Hz	AC 100 - 240 V, 50 / 60 Hz	AC 100 - 240 V, 50 / 60 Hz	AC 100 - 240 V, 50 / 60 Hz	AC 100 - 240 V, 50 / 60 Hz	AC 100 - 240 V, 50 / 60 Hz
	Typical Power Consumption		31 W	25 W	23 W	14 W	18 W	16 W	16 W	11 W	11 W	12 W
	Maximum Power Consumption		243 W	220 W	222 W	204 W	196 W	186 W	164 W	156 W	155 W	149 W
	Standby Mode		0.4 W	0.3 W	0.4 W	0.3 W	0.35 W	0.35 W	0.5 W or less	0.5 W or less	0.5 W or less	0.27 W
Features & Functions	Webcam		-	-	5 megapixel, built-in microphone, Windows Hello supported	-	-	-	-	-	-	-
	Preset Modes		User1, User2, sRGB, Paper, Movie, DICOM	User1, User2, Eco, sRGB, Paper, BT.709, DCI-P3, Display P3, DICOM	User1, User2, sRGB, Paper, Movie, DICOM	User1, User2, Eco, sRGB, Paper, BT.709, DICOM	User1, User2, sRGB, Paper, Movie, DICOM	User1, User2, sRGB, Paper, Movie, DICOM	User1, User2, sRGB, Paper, Movie, DICOM	User1, User2, sRGB, Paper, Movie, DICOM	User1, User2, sRGB, Paper, Movie, DICOM	User1, User2, sRGB, Paper, Movie, DICOM
	Simultaneous Display		Picture by Picture (2 PbyP, 3 PbyP, 4PbyP), Picture in Picture (PinP)	Picture by Picture (2 PbyP)	Picture by Picture (2 PbyP)	Picture by Picture (2 PbyP)	Picture by Picture (2 PbyP)	Picture by Picture (2 PbyP)	-	-	-	Picture by Picture (2 PbyP)
	Automatic Brightness Control		Auto EcoView	Auto EcoView	Auto EcoView	Auto EcoView	Auto EcoView	Auto EcoView	Auto EcoView	Auto EcoView	Auto EcoView	Auto EcoView
Physical Specifications	Dimensions (Landscape, W x H x D)		966.8 x 631 x 225.2 mm	893.9 x 416.9 - 611.9 x 247.1 - 250.2 mm	819.5 x 414.5 - 609.5 x 242 - 250 mm	816 x 382.7 - 577.7 x 242.6 - 250.2 mm	712.2 x 427.3 - 622.2 x 242.4 - 250.7 mm	611.6 x 370.8 - 565.4 x 242 - 250.1 mm	611.4 x 368.6 - 545.2 x 230 mm	531 x 356.2 - 538.4 x 230 mm	537.8 x 332.4 - 523.6 x 230 mm	611.6 x 376.3 - 545.3 x 230 mm
	Dimensions (Without Stand, W x H x D)		966.8 x 571 x 89.9 mm	893.9 x 402.2 x 112.3 mm	819.5 x 385 x 103.1 mm	816 x 368 x 92 mm	712.2 x 415.3 x 59 mm	611.6 x 358.8 x 60.5 mm	611.4 x 356.6 x 56 mm	531 x 344.2 x 53.7 mm	537.8 x 320.4 x 57.4 mm	611.6 x 364.3 x 60.7 mm
	Net Weight		15.9 kg	13.0 kg	12.1 kg	11.9 kg	9.4 kg	8.2 kg	8.5 kg	7.6 kg	7.2 kg	8.6 kg
	Net Weight (Without Stand)		15.2 kg	10.3 kg	9.2 kg	9.3 kg	6.7 kg	5.5 kg	5.7 kg	4.9 kg	4.5 kg	5.8 kg
	Height Adjustment Range		-	195 mm	195 mm	195 mm	195 mm	195 mm	176.6 mm	182.2 mm	191.2 mm	169 mm
	Tilt / Swivel		- / -	35° Up, 5° Down / 70°	35° Up, 5° Down / 90°	35° Up, 5° Down / 90°	35° Up, 5° Down / 90°	35° Up, 5° Down / 90°	35° Up, 5° Down / 90°	35° Up, 5° Down / 344°	35° Up, 5° Down / 344°	35° Up, 5° Down / 344°
Pivot		-	70°	-	90°	90° (clockwise)	90° (clockwise)	90° (both clockwise and counter clockwise)	90° (both clockwise and counter clockwise)	90° (both clockwise and counter clockwise)	90° (both clockwise and counter clockwise)	
Hole Spacing (VESA Standard)		100 x 100 mm, 200 x 200 mm	100 x 100 mm	100 x 100 mm	100 x 100 mm	100 x 100 mm	100 x 100 mm	100 x 100 mm	100 x 100 mm	100 x 100 mm	100 x 100 mm	
Certifications & Standards (Please contact EIZO for the latest information.)			EPEAT Silver with Climate+, TÜV/Ergonomics, TÜV/Low blue light content, TÜV/Flicker Free, TÜV/GS, RCM, CE, UKCA, CB, cTUVus, FCC-B, CAN ICES (B), TÜV/S, PSE, VCCI-B, EPA ENERGY STAR, RoHS, WEEE, China RoHS, CCC	TCO Certified, generation 10, EPEAT Gold with Climate+, TÜV/Ergonomics, TÜV/Low blue light content, TÜV/Flicker Free, TÜV/GS, RCM, CE, UKCA, CB, cTUVus, FCC-B, CAN ICES (B), TÜV/S, PSE, VCCI-B, EPA ENERGY STAR, RoHS, WEEE, China RoHS, CCC	TCO Certified, generation 10, EPEAT Gold with Climate+, TÜV/Ergonomics, TÜV/Low blue light content, TÜV/Flicker Free, TÜV/GS, RCM, CE, UKCA, CB, cTUVus, FCC-B, CAN ICES (B), TÜV/S, PSE, VCCI-B, EPA ENERGY STAR, RoHS, WEEE, China RoHS, CCC	TCO Certified, generation 10, EPEAT Gold with Climate+, TÜV/Ergonomics, TÜV/Low blue light content, TÜV/Flicker Free, TÜV/GS, RCM, CE, UKCA, CB, cTUVus, FCC-B, CAN ICES (B), TÜV/S, PSE, VCCI-B, EPA ENERGY STAR, RoHS, WEEE, China RoHS, CCC	TCO Certified, generation 10, EPEAT Gold with Climate+, TÜV/Ergonomics, TÜV/Low blue light content, TÜV/Flicker Free, TÜV/GS, RCM, CE, UKCA, CB, cTUVus, FCC-B, CAN ICES (B), TÜV/S, PSE, VCCI-B, EPA ENERGY STAR, RoHS, WEEE, China RoHS, CCC	TCO Certified, generation 10, EPEAT Gold with Climate+, TÜV/Ergonomics, TÜV/Low blue light content, TÜV/Flicker Free, TÜV/GS, RCM, CE, UKCA, CB, cTUVus, FCC-B, CAN ICES (B), TÜV/S, PSE, VCCI-B, EPA ENERGY STAR, RoHS, WEEE, China RoHS, CCC, EAC	TCO Certified, generation 10, EPEAT Gold with Climate+, TÜV/Ergonomics, TÜV/Low blue light content, TÜV/Flicker Free, TÜV/GS, RCM, CE, UKCA, CB, cTUVus, FCC-B, CAN ICES (B), TÜV/S, PSE, VCCI-B, EPA ENERGY STAR, RoHS, WEEE, China RoHS, CCC, EAC	TCO Certified, generation 10, EPEAT Gold with Climate+, TÜV/Ergonomics, TÜV/Low blue light content, TÜV/Flicker Free, TÜV/GS, RCM, CE, UKCA, CB, cTUVus, FCC-B, CAN ICES (B), TÜV/S, PSE, VCCI-B, EPA ENERGY STAR, RoHS, WEEE, China RoHS, CCC, EAC	TCO Certified, generation 10, EPEAT Gold with Climate+, TÜV/Ergonomics, TÜV/Low blue light content, TÜV/Flicker Free, TÜV/GS, RCM, CE, UKCA, CB, cTUVus, FCC-B, CAN ICES (B), TÜV/S, PSE, VCCI-B, EPA ENERGY STAR, RoHS, WEEE, China RoHS, CCC, EAC	TCO Certified, generation 10, EPEAT Gold with Climate+, TÜV/Ergonomics, TÜV/Low blue light content, TÜV/Flicker Free, TÜV/GS, RCM, CE, UKCA, CB, cTUVus, FCC-B, CAN ICES (B), TÜV/S, PSE, VCCI-B, EPA ENERGY STAR, RoHS, WEEE, China RoHS, CCC
Dedicated Software	Monitor Control Utility Screen InStyle		Supported	Supported	Supported	Supported	Supported	Supported	Supported	Supported	Supported	Supported
Supplied Accessories (May vary by country. Please contact EIZO for details.)	Signal Cables		USB Type-C (2 m), DisplayPort (2 m)	USB Type-C (1.5 m), DisplayPort (2 m)	USB Type-C (2 m), DisplayPort (2 m)	USB Type-C (1.5 m), DisplayPort (2 m)	USB Type-C (1.5 m)	USB Type-C (1.5 m)	USB Type-C (2 m)	USB Type-C (2 m)	USB Type-C (2 m)	USB Type-C (1.5 m)
	Others		EV4340X: AC power cord (2 m), USB Type-A - USB Type-B cable (2 m), remote control, VESA cover, stand (L, R), stand mounting screw x 4, setup guide EV4340X-F: AC power cord (2 m), USB Type-A - USB Type-B cable (2 m), remote control, setup guide	AC power cord (2 m), USB Type-A - USB Type-B cable (2 m), connector cover, setup guide	AC power cord (2 m), USB Type-A - USB Type-B cable (2 m), connector cover, setup guide	AC power cord (2 m), USB Type-A - USB Type-B cable (2 m), connector cover, setup guide	AC power cord (2 m), setup guide	AC power cord (2 m), setup guide	AC power cord (2 m), setup guide	AC power cord (2 m), setup guide	AC power cord (2 m), setup guide	AC power cord (2 m), setup guide
Warranty ¹			5 Years	7 Years	5 Years	7 Years	5 Years	5 Years	5 Years	5 Years	5 Years	7 Years
Zero Bright Pixels ²			-	Yes	Yes	Yes	Yes	Yes	Yes	Yes	Yes	Yes
Dimensions Drawing (Unit: mm)												

With current LCD technology, a panel may contain a limited number of missing or flickering pixels. If the monitor is left on continuously over a long period of time, dark smudges or burn-in may appear.

To maximize the life of the monitor, we recommend the monitor be turned off periodically.

¹ Usage time is limited to 30,000 hours. ² 6 months from the date of purchase.

FlexScan

Specifications



EV2720S



EV2485



EV2480



EV2410R



EV2400R



EV2360



S2134



S1934



S1734



S1504

		New Standard				
Model Variations	With Stand	Black	EV2720S-BK	EV2485-BK	EV2480-BK	EV2410R-BK
		White	EV2720S-WT	EV2485-WT	EV2480-WT	EV2410R-WT
		Gray	-	-	-	-
	Without Stand	Black	EV2720S-FBK	EV2485-FBK	EV2480-FBK	EV2410R-FBK
		White	EV2720S-FWT	EV2485-FWT	EV2480-FWT	EV2410R-FWT
		Gray	-	-	-	-
Panel	Type	IPS	IPS	IPS	IPS	IPS
	Backlight	LED	LED	LED	LED	LED
	Size	27.0" (68.5 cm)	24.1" (61.1 cm)	23.8" (60.5 cm)	24.1" (61.1 cm)	23.8" (60.5 cm)
	Native Resolution	2560 x 1440 (16:9 aspect ratio)	1920 x 1200 (16:10 aspect ratio)	1920 x 1080 (16:9 aspect ratio)	1920 x 1200 (16:10 aspect ratio)	1920 x 1080 (16:9 aspect ratio)
	Viewable Image Size (H x V)	596.7 x 335.7 mm	518.4 x 324 mm	527 x 296.5 mm	518.4 x 324 mm	527 x 296.5 mm
	Pixel Pitch (H x V)	0.233 x 0.233 mm	0.270 x 0.270 mm	0.275 x 0.275 mm	0.270 x 0.270 mm	0.275 x 0.275 mm
	Pixel Density	109 ppi	94 ppi	93 ppi	94 ppi	93 ppi
	Display Colors	16.77 million	16.77 million	16.77 million	16.77 million	16.77 million
	Viewing Angles (H / V, typ.)	178° / 178°	178° / 178°	178° / 178°	178° / 178°	178° / 178°
	Brightness (typ.)	350 cd/m ²	250 cd/m ²	250 cd/m ²	350 cd/m ²	250 cd/m ²
	Contrast Ratio (typ.)	1500:1	1000:1	1000:1	1300:1	1500:1
	Response Time (typ.)	5 ms (gray-to-gray)	5 ms (gray-to-gray)	5 ms (gray-to-gray)	5 ms (gray-to-gray)	5 ms (gray-to-gray)
Video Signals	Input Terminals	USB Type-C (DisplayPort Alt Mode, HDCP 1.3), DisplayPort (HDCP 1.3), HDMI (HDCP 1.4)	USB Type-C (DisplayPort Alt Mode, HDCP 1.3), DisplayPort (HDCP 1.3), HDMI (HDCP 1.4)	USB Type-C (DisplayPort Alt Mode, HDCP 1.3), DisplayPort (HDCP 1.3), HDMI (HDCP 1.4)	USB Type-C (DisplayPort Alt Mode, HDCP 1.3), DisplayPort (HDCP 1.3), HDMI (HDCP 1.4)	DisplayPort (HDCP 1.3), HDMI (HDCP 1.4), DVI-D (HDCP 1.4), D-Sub mini 15 pin
	Output Terminals	-	-	-	-	-
USB	Upstream	USB 5Gbps: Type-C (DisplayPort Alt Mode, Power Delivery Source 70 W max.)	USB 5Gbps: Type-C (DisplayPort Alt Mode, Power Delivery Source 70 W max.)	USB 5Gbps: Type-C (DisplayPort Alt Mode, Power Delivery Source 70 W max.)	USB 5Gbps: Type-C (DisplayPort Alt Mode, Power Delivery Source 70 W max.)	USB 5Gbps: Type-B
	Downstream	USB 5Gbps: Type-A x 4	USB 5Gbps: Type-A x 4	USB 5Gbps: Type-A x 4	USB 5Gbps: Type-A x 4	USB 5Gbps: Type-A x 4
	USB LAN Adapter	-	-	-	-	-
Audio	Speakers	1.0 W + 1.0 W	1.0 W + 1.0 W	1.0 W + 1.0 W	1.0 W + 1.0 W	1.0 W + 1.0 W
	Output Terminals	Headphones (Stereo mini jack)	Headphones (Stereo mini jack)	Headphones (Stereo mini jack)	Headphones (Stereo mini jack)	Headphones (Stereo mini jack)
Power	Power Input	AC 100 - 240 V, 50 / 60 Hz	AC 100 - 240 V, 50 / 60 Hz	AC 100 - 240 V, 50 / 60 Hz	AC 100 - 240 V, 50 / 60 Hz	AC 100 - 240 V, 50 / 60 Hz
	Typical Power Consumption	14 W	12 W	11 W	8 W	8 W
	Maximum Power Consumption	149 W	146 W	142 W	54 W	43 W
	Standby Mode	0.4 W or less	0.5 W or less	0.5 W or less	0.5 W or less	0.37 W
Features & Functions	Webcam	-	-	-	-	-
	Preset Modes	User1, User2, sRGB, Paper, Movie, DICOM	User1, User2, sRGB, Paper, Movie, DICOM	User1, User2, sRGB, Paper, Movie, DICOM	User1, User2, sRGB, Paper, Movie, DICOM	User1, User2, sRGB, Paper, Movie, DICOM
	Simultaneous Display	Picture by Picture (2 PbyP)	-	-	-	-
	Automatic Brightness Control	Auto EcoView	Auto EcoView	Auto EcoView	Auto EcoView	Auto EcoView
Physical Specifications	Dimensions (Landscape, W x H x D)	611.6 x 376.3 - 545.3 x 230 mm	531 x 356.2 - 538.4 x 230 mm	537.8 x 332.4 - 523.6 x 230 mm	531 x 358.4 - 488.3 x 233 mm	537.8 x 333.6 - 473.6 x 233 mm
	Dimensions (Without Stand, W x H x D)	611.6 x 364.3 x 59.7 mm	531 x 344.2 x 53.7 mm	537.8 x 320.4 x 57.4 mm	531 x 345.2 x 57 mm	537.8 x 317.5 x 57 mm
	Net Weight	8.5 kg	7.6 kg	7.4 kg	6.0 kg	5.6 kg
	Net Weight (Without Stand)	5.7 kg	4.9 kg	4.7 kg	3.9 kg	3.5 kg
	Height Adjustment Range	169 mm	182.2 mm	191.2 mm	129.9 mm	140 mm
	Tilt / Swivel	35° Up, 5° Down / 344°	35° Up, 5° Down / 344°	35° Up, 5° Down / 344°	35° Up, 5° Down / 344°	35° Up, 5° Down / 344°
	Pivot	90° (both clockwise and counter clockwise)	90° (both clockwise and counter clockwise)	90° (both clockwise and counter clockwise)	90° (both clockwise and counter clockwise)	90° (both clockwise and counter clockwise)
	Hole Spacing (VESA Standard)	100 x 100 mm	100 x 100 mm	100 x 100 mm	100 x 100 mm	100 x 100 mm
Certifications & Standards	(Please contact EIZO for the latest information.)	TCO Certified, generation 10, EPEAT Gold with Climate+, TÜV/Ergonomics, TÜV/Low blue light content, TÜV/Flicker Free, TÜV/GS, RCM, CE, UKCA, CB, cTUVus, FCC-B, CAN ICES (B), TÜV/S, PSE, VCCI-B, EPA ENERGY STAR, RoHS, WEEE, China RoHS, CCC	TCO Certified, generation 10, EPEAT Gold with Climate+, TÜV/Ergonomics, TÜV/Low blue light content, TÜV/Flicker Free, TÜV/GS, RCM, CE, UKCA, CB, cTUVus, FCC-B, CAN ICES (B), TÜV/S, PSE, VCCI-B, EPA ENERGY STAR, RoHS, WEEE, China RoHS, CCC, EAC	TCO Certified, generation 10, EPEAT Gold with Climate+, TÜV/Ergonomics, TÜV/Low blue light content, TÜV/Flicker Free, TÜV/GS, RCM, CE, UKCA, CB, cTUVus, FCC-B, CAN ICES (B), TÜV/S, PSE, VCCI-B, EPA ENERGY STAR, RoHS, WEEE, China RoHS, CCC, EAC	TCO Certified, generation 10, EPEAT Gold with Climate+, TÜV/Ergonomics, TÜV/Low blue light content, TÜV/Flicker Free, TÜV/GS, RCM, CE, UKCA, CB, cTUVus, FCC-B, CAN ICES (B), TÜV/S, PSE, VCCI-B, EPA ENERGY STAR, RoHS, WEEE, China RoHS, CCC	TCO Certified, generation 9, EPEAT Silver with Climate+, TÜV/Ergonomics, TÜV/Low blue light content, TÜV/Flicker Free, TÜV/GS, RCM, CE, UKCA, CB, cTUVus, VCCI-B, EPA ENERGY STAR, RoHS, WEEE, China RoHS, CCC, EAC
Dedicated Software	Monitor Control Utility Screen InStyle	Supported	Supported	Supported	Supported	Supported
Supplied Accessories	Signal Cables	USB Type-C (2 m)	USB Type-C (2 m)	USB Type-C (2 m)	DisplayPort (2 m)	DisplayPort (2 m)
	Others	AC power cord (2 m), setup guide	AC power cord (2 m), setup guide	AC power cord (2 m), setup guide	AC power cord (2 m), USB Type-A - USB Type-B cable (2 m), setup guide	AC power cord (2 m), USB Type-A - USB Type-B cable (2 m), setup guide
Warranty ¹		7 Years	5 Years	5 Years	7 Years	5 Years
Zero Bright Pixels ²		Yes	Yes	Yes	Yes	Yes
Dimensions Drawing (Unit: mm)						

		Basic	Square					
Model Variations	With Stand	Black	EV2400R-BK	EV2360-BK	S2134-HBK	S1934-HBK (Height Adjustable Stand) S1934-TBK (Tilt Stand)	S1734-HBK (Height Adjustable Stand) S1734-TBK (Tilt Stand)	S1504-TBK
		White	EV2400R-WT	EV2360-WT	-	-	-	-
		Gray	-	-	S2134-HGY	S1934-HGY (Height Adjustable Stand) S1934-TGY (Tilt Stand)	S1734-HGY (Height Adjustable Stand) S1734-TGY (Tilt Stand)	S1504-TGY
	Without Stand	Black	EV2400R-FBK	EV2360-FBK	S2134-FBK	S1934-FBK	S1734-FBK	S1504-FBK
		White	EV2400R-FWT	EV2360-FWT	-	-	-	-
		Gray	-	-	S2134-FGY	S1934-FGY	S1734-FGY	S1504-FGY
Panel	Type	IPS	IPS	IPS	IPS	IPS	IPS	IPS
	Backlight	LED	LED	LED	LED	LED	LED	LED
	Size	23.8" (60.5 cm)	22.5" (57.2 cm)	21.3" (54.0 cm)	19" (48.0 cm)	17.0" (43.3 cm)	15.0" (38.0 cm)	15.0" (38.0 cm)
	Native Resolution	1920 x 1080 (16:9 aspect ratio)	1920 x 1200 (16:10 aspect ratio)	1600 x 1200 (4:3 aspect ratio)	1280 x 1024 (5:4 aspect ratio)	1280 x 1024 (5:4 aspect ratio)	1024 x 768 (4:3 aspect ratio)	1024 x 768 (4:3 aspect ratio)
	Viewable Image Size (H x V)	527 x 296.5 mm	488.2 x 297.2 mm	432 x 324 mm	374.8 x 299.8 mm	337.9 x 270.3 mm	304.1 x 228.1 mm	304.1 x 228.1 mm
	Pixel Pitch (H x V)	0.275 x 0.275 mm	0.254 x 0.248 mm	0.270 x 0.270 mm	0.293 x 0.293 mm	0.264 x 0.264 mm	0.297 x 0.297 mm	0.297 x 0.297 mm
	Pixel Density	93 ppi	101 ppi	94 ppi	87 ppi	96 ppi	86 ppi	86 ppi
	Display Colors	16.77 million	16.77 million	16.77 million	16.77 million	16.77 million	16.77 million	16.77 million
	Viewing Angles (H / V, typ.)	178° / 178°	178° / 178°	178° / 178°	178° / 178°	178° / 178°	178° / 178°	176° / 176°
	Brightness (typ.)	350 cd/m ²	250 cd/m ²	500 cd/m ²	250 cd/m ²	250 cd/m ²	250 cd/m ²	400 cd/m ²
	Contrast Ratio (typ.)	1500:1	1000:1	1800:1	1000:1	1000:1	1000:1	2500:1
	Response Time (typ.)	5 ms (gray-to-gray)	5 ms (gray-to-gray)	6 ms (gray-to-gray)	14 ms (gray-to-gray)	5 ms (gray-to-gray)	23 ms (black-white-black)	23 ms (black-white-black)
Video Signals	Input Terminals	USB Type-C (DisplayPort Alt Mode, HDCP 1.3), DisplayPort (HDCP 1.3), HDMI (HDCP 1.4)	USB Type-C (DisplayPort Alt Mode, HDCP 1.3), DisplayPort (HDCP 1.3), HDMI (HDCP 1.4)	DisplayPort (HDCP 1.3), HDMI (HDCP 1.4), DVI-D (HDCP 1.4), D-Sub mini 15 pin	DisplayPort (HDCP 1.3), HDMI (HDCP 1.4), DVI-D (HDCP 1.4), D-Sub mini 15 pin	DisplayPort (HDCP 1.3), DVI-D (HDCP 1.4), D-Sub mini 15 pin	DisplayPort (HDCP 1.3), DVI-D (HDCP 1.4), D-Sub mini 15 pin	DVI-D, D-Sub mini 15 pin
	Output Terminals	-	-	-	-	-	-	-
USB	Upstream	USB 5Gbps: Type-B	USB 5Gbps: Type-B	USB 2.0: Type-B	-	-	-	-
	Downstream	USB 5Gbps: Type-A x 2	USB 5Gbps: Type-A x 2	USB 2.0: Type-A x 2	-	-	-	-
	USB LAN Adapter	-	-	-	-	-	-	-
Audio	Speakers	1.0 W + 1.0 W	1.0 W + 1.0 W	-	0.5 W + 0.5 W	-	0.5 W + 0.5 W	0.5 W + 0.5 W
	Output Terminals	Headphones (Stereo mini jack)	Headphones (Stereo mini jack)	Headphones (Stereo mini jack)	Headphones (Stereo mini jack)	Headphones (Stereo mini jack)	Headphones (Stereo mini jack)	Headphones (Stereo mini jack)
Power	Power Input	AC 100 - 240 V, 50 / 60 Hz	AC 100 - 240 V, 50 / 60 Hz	AC 100 - 240 V, 50 / 60 Hz	AC 100 - 240 V, 50 / 60 Hz	AC 100 - 240 V, 50 / 60 Hz	AC 100 - 240 V, 50 / 60 Hz	AC 100 - 240 V, 50 / 60 Hz
	Typical Power Consumption	8 W	11 W	13 W	9 W	6 W	5 W	5 W
	Maximum Power Consumption	43 W	37 W	42 W	21 W	13 W	14 W	14 W
	Standby Mode	0.37 W	0.5 W or less	0.5 W or less	0.5 W or less	0.5 W or less	0.5 W or less	0.5 W or less
Features & Functions	Webcam	-	-	-	-	-	-	-
	Preset Modes	User1, User2, sRGB, Eco, Paper, Movie, DICOM	User1, User2, sRGB, Paper, Movie, DICOM	User1, User2, sRGB, Paper, Movie, DICOM	User1, User2, sRGB, Paper, Movie, DICOM	User1, User2, sRGB, Paper, Movie, DICOM	User1, User2, sRGB, Paper, Movie, DICOM	User1, User2, sRGB, Paper, Movie, DICOM
	Simultaneous Display	-	-	-	-	-	-	-
	Automatic Brightness Control	Auto EcoView	Auto EcoView	Auto EcoView	Auto EcoView	Auto EcoView	Auto EcoView	Auto EcoView
Physical Specifications	Dimensions (Landscape, W x H x D)	537.8 x 333.6 - 473.6 x 233 mm	499 x 333.9 - 473.9 x 233 mm	465 x 453 - 535 x 208.5 mm	S1934-H: 405 x 406.5 - 506.5 x 205 mm S1934-T: 405 x 414 x 205 mm	S1734-H: 367 x 391.5 - 491.5 x 204.6 mm S1734-T: 367 x 383.8 x 188 mm	S1504-H: 346 x 349 x 157 mm	S1504-T: 346 x 349 x 157 mm
	Dimensions (Without Stand, W x H x D)	537.8 x 317.5 x 57 mm	499 x 321.3 x 53.6 mm	465 x 361 x 64 mm	405 x 334 x 61.5 mm	367 x 304 x 59 mm	346 x 280 x 69 mm	346 x 280 x 69 mm
	Net Weight	5.6 kg	5.5 kg	8.1 kg	S1934-H: 5.6 kg S1934-T: 4.6 kg	S1734-H: 5.1 kg S1734-T: 4.1 kg	4.7 kg	4.7 kg
	Net Weight (Without Stand)	3.5 kg	3.4 kg	5.1 kg	3.8 kg	3.3 kg	3.4 kg	3.4 kg
	Height Adjustment Range	140 mm	140 mm	82 mm	S1934-H: 100 mm S1934-T: -	S1734-H: 100 mm S1734-T: -	-	-
	Tilt / Swivel	35° Up, 5° Down / 344°	35° Up, 5° Down / 344°	40° Up, 0° Down / 35° Right, 35° Left	S1934-H: 30° Up, 0° Down / 35° Right, 35° Left S1934-T: 30° Up, 5° Down / -	S1734-H: 30° Up, 0° Down / 35° Right, 35° Left S1734-T: 30° Up, 5° Down / -	30° Up, 0° Down / -	30° Up, 0° Down / -
	Pivot	90° (both clockwise and counter clockwise)	90° (both clockwise and counter clockwise)	90° (clockwise)	S1934-H: 90° (clockwise) S1934-T: -	S1734-H: 90° (clockwise) S1734-T: -	-	-
	Hole Spacing (VESA Standard)	100 x 100 mm	100 x 100 mm	100 x 100 mm	100 x 100 mm	100 x 100 mm	100 x 100 mm, 75 x 75 mm	100 x 100 mm, 75 x 75 mm
Certifications & Standards	(Please contact EIZO for the latest information.)	TCO Certified, generation 10, EPEAT Gold with Climate+, TÜV/Ergonomics, TÜV/Low blue light content, TÜV/Flicker Free, TÜV/GS, RCM, CE, UKCA, CB, cTUVus, FCC-B, CAN ICES (B), TÜV/S, PSE, VCCI-B, EPA ENERGY STAR, RoHS, WEEE, China RoHS, CCC	TCO Certified, generation 9, EPEAT Silver with Climate+, TÜV/Ergonomics, TÜV/Low blue light content, TÜV/Flicker Free, TÜV/GS, RCM, CE, UKCA, CB, cTUVus, VCCI-B, EPA ENERGY STAR, RoHS, WEEE, China RoHS, CCC, EAC	TÜV/Ergonomics, TÜV/GS, RCM, CE, UKCA, CB, cTUVus, FCC-B, CAN ICES (B), TÜV/S, PSE, VCCI-B, EPA ENERGY STAR, RoHS, WEEE, China RoHS, CCC, EAC	TÜV/Ergonomics, TÜV/GS, RCM, CE, UKCA, CB, cTUVus, FCC-B, CAN ICES (B), TÜV/S, PSE, VCCI-B, EPA ENERGY STAR, RoHS, WEEE, China RoHS, CCC, EAC	TÜV/Ergonomics, TÜV/GS, RCM, CE, UKCA, CB, cTUVus, FCC-B, CAN ICES (B), TÜV/S, PSE, VCCI-B, EPA ENERGY STAR, RoHS, WEEE, China RoHS, CCC, EAC	TÜV/Ergonomics, TÜV/GS, RCM, CE, UKCA, CB, cTUVus, FCC-B, CAN ICES (B), TÜV/S, PSE, VCCI-B, EPA ENERGY STAR, RoHS, WEEE, China RoHS, CCC, EAC	TÜV/Ergonomics, TÜV/GS, RCM, CE, UKCA, CB, cTUVus, FCC-B, CAN ICES (B), TÜV/S, PSE, VCCI-B, EPA ENERGY STAR, RoHS, WEEE, China RoHS, CCC, EAC
Dedicated Software	Monitor Control Utility Screen InStyle	Supported	Supported	-	-	-	-	-
Supplied Accessories	Signal Cables	DisplayPort (2 m)	DisplayPort (2 m)	DVI-D (2 m), D-Sub mini 15 pin (1.8 m)	DVI-D (2 m), D-Sub mini 15 pin (1.8 m)	DVI-D (2 m), D-Sub mini 15 pin (1.8 m)	DVI-D (2 m), D-Sub mini 15 pin (1.8 m)	DVI-D (2 m), D-Sub mini 15 pin (1.8 m)
	Others	AC power cord (2 m), USB Type-A - USB Type-B cable (2 m), setup guide	AC power cord (2 m), USB Type-A - USB Type-B cable (2 m), setup guide	AC power cord (2 m), USB Type-A - USB Type-B cable (2 m), setup guide	AC power cord (2 m), audio cable (2.1 m), setup guide	AC power cord (2 m), audio cable (2.1 m), setup guide	AC power cord (2 m), audio cable (2.1 m), setup guide	AC power cord (2 m), audio cable (2.1 m), setup guide
Warranty ¹		7 Years	5 Years	5 Years	5 Years	5 Years	5 Years	5 Years
Zero Bright Pixels ²		Yes	Yes	Yes	Yes	Yes	Yes	Yes
Dimensions Drawing (Unit: mm)								

¹With current LCD technology, a panel may contain a limited number of missing or flickering pixels. If the monitor is left on continuously over a long period of time, dark smudges or burn-in may appear. To maximize the life of the monitor, we recommend the monitor be turned off periodically. ²

EIZO Corporation

153 Shimokashiwano, Hakusan, Ishikawa 924-8566 Japan
Phone +81-76-277-6794

<https://www.eizoglobal.com>

EIZO, the EIZO Logo, FlexScan, Screen InStyle, ColorEdge, CuratOR, RadiForce, Raptor, Re/Vue, and SafeGuard are trademarks or registered trademarks of EIZO Corporation in Japan and other countries. USB Type-C is a registered trademark of USB Implementers Forum, Inc. DisplayPort is a trademark of the Video Electronics Standards Association in the United States and other countries. The terms HDMI, HDMI High-Definition Multimedia Interface, HDMI trade dress and the HDMI Logos are trademarks or registered trademarks of HDMI Licensing Administrator, Inc. Windows and Windows Hello are registered trademarks of Microsoft Corporation in the United States and other countries. macOS and macOS Sierra are trademarks of Apple Inc. ENERGY STAR is a registered trademark of the United States Environmental Protection Agency in the United States and other countries. DICOM is the registered trademark of the National Electrical Manufacturers Association for its standards publications relating to digital communications of medical information. All other company names, product names, and logos are trademarks or registered trademarks of their respective owners.

Some screen images are used with permission from Microsoft. Specifications are subject to change without notice.

Copyright © 2026 EIZO Corporation. All rights reserved. (260603)

